

NURSERY ROAD

BOWDEN CEMETARY
= LOW (THIRD) PRIORITY

SECONDARY HIGHWAY 587

27 AVENUE

26 AVENUE

24A ST CLOSE

23 AVE CLOSE

22 AVENUE

18 AVENUE

17 AVENUE

15 AVE

13 AVE

21 STREET

TOWN OF BOWDEN
APPENDIX A

SNOW REMOVAL AND SANDING PRIORITY MAP
CURRENT TO DECEMBER 13, 2011

- █ = HIGH (FIRST) PRIORITY
- █ = MEDIUM (SECOND) PRIORITY
- █ = LOW (THIRD) PRIORITY

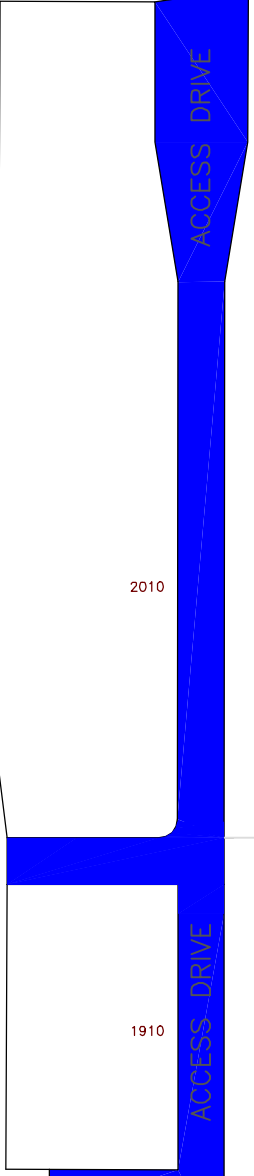
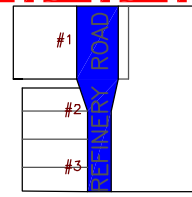

HIGHWAY 2

RANGE ROAD 10A

ACCESS DRIVE

ACCESS DRIVE

2010 2101

1910

1711

1710

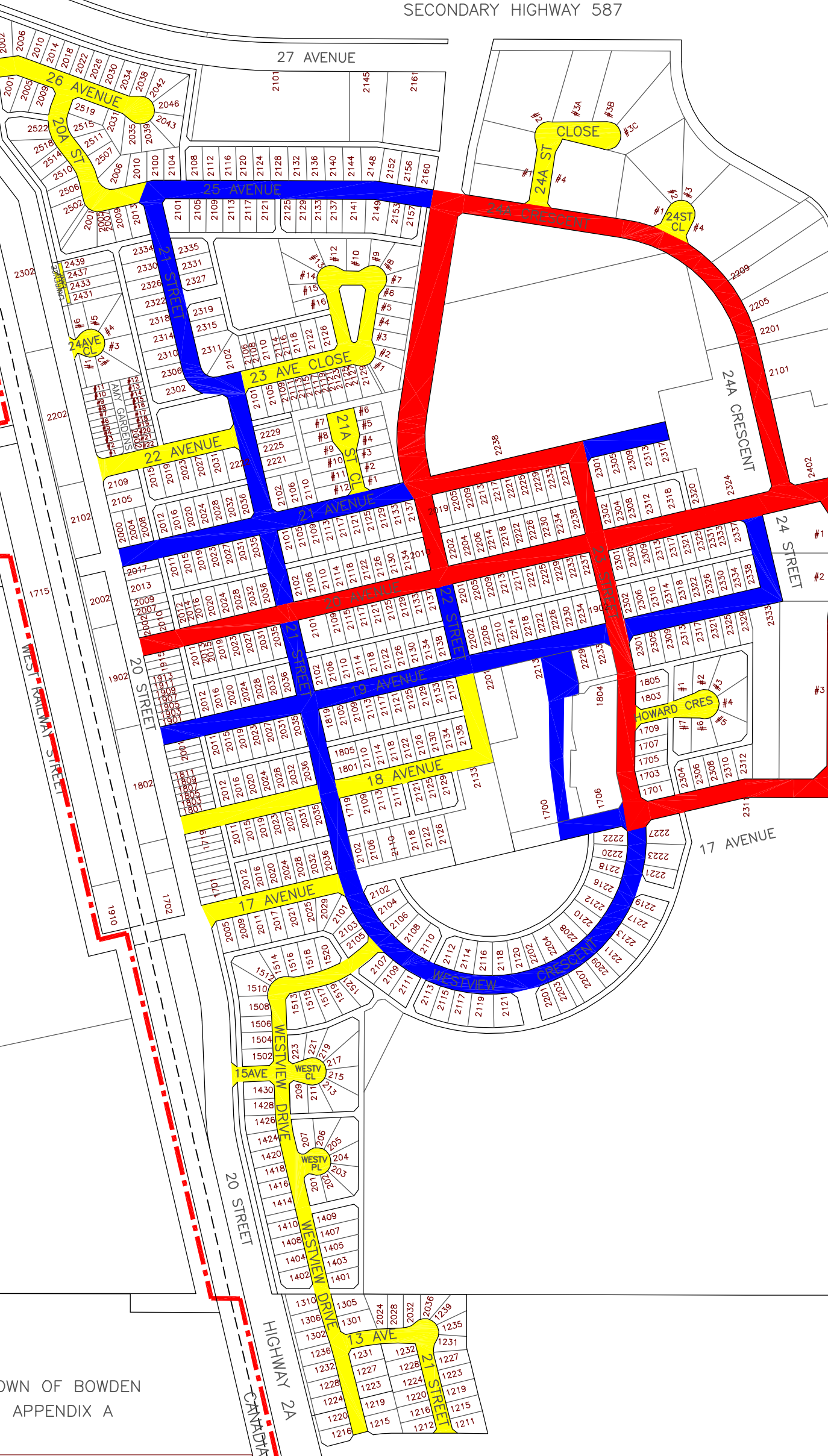

WEST KAILUA STREET

20 STREET

HIGHWAY 2A
CANADIAN PACIFIC RAILWAY

24A ST CLOSE

24A ST CLOSE

24A ST CLOSE

24A ST CLOSE

24A ST CLOSE

24A ST CLOSE

24A ST CLOSE

24A ST CLOSE

24A ST CLOSE

24A ST CLOSE

24A ST CLOSE

24A ST CLOSE

24A ST CLOSE

24A ST CLOSE

24A ST CLOSE

24A ST CLOSE

24A ST CLOSE

24A ST CLOSE

24A ST CLOSE